

MAINE TURNPIKE ADVISORY

LANES CHANGING AS YORK TOLL SWITCHES FROM OLD TO NEW

The switch is at 12:01 AM, on Wednesday, September 15, as the Maine Turnpike's newly completed York toll plaza replaces the former, 50-year-old plaza to the south. Dismantling the old plaza begins with the sequenced removal of the tollbooth canopy with a series of lane shifts to allow workers to complete this task safely with minimal inconvenience to travelers.

A speed limit of **10 mph** is essential to ensuring that drivers can pass safely through the old tollbooth lanes.

STEP ONE

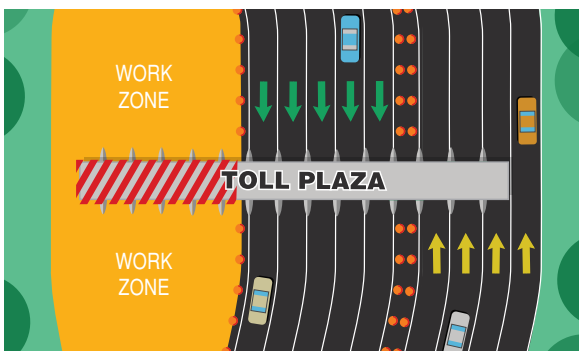

Southbound traffic will be diverted through the center tollbooth lanes.
Northbound traffic stays to the right.

STEP TWO

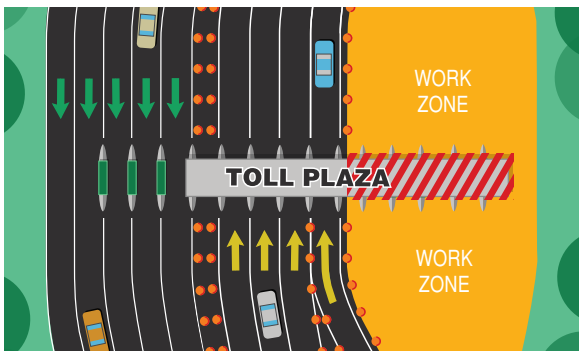

Northbound traffic diverted through the center tollbooth lanes.
Southbound traffic stays to the right.

STEP THREE

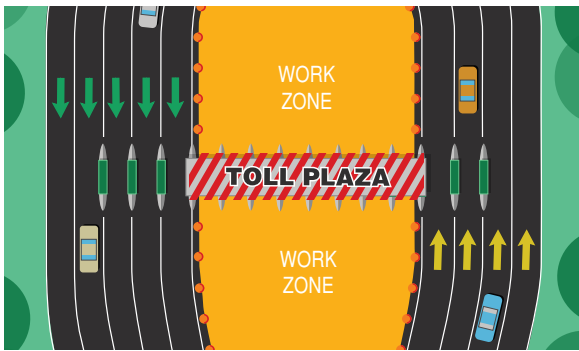

Both southbound and northbound traffic keep to the right hand tollbooth lanes.

YORK TOLL PLAZA  Canopy Removal

Drivers approaching this work zone should keep inside the orange construction barrels and watch out for other vehicles, especially when approaching narrow tollbooth lanes.



Safe | Reliable | Sustainable

maineturnpike.com

Thank-you for your safe driving and observing reduced speeds in work zones.